



# INTERIOR DOORS

**M.J.N. McNAUGHTON**  
 LIMITED  
 EST 1937  
 joinery & door manufacturers

42 Frost Road • Mt Roskill • Auckland 4  
 PO Box 27 061. Mt Roskill  
 Telephone 620 9059 • Fax 620 7585

All doors are constructed from plantation grown pine, and are supplied protected with a water repellent ready for stain or paint.  
 USE ONLY OIL BASED STAIN OR PAINT.

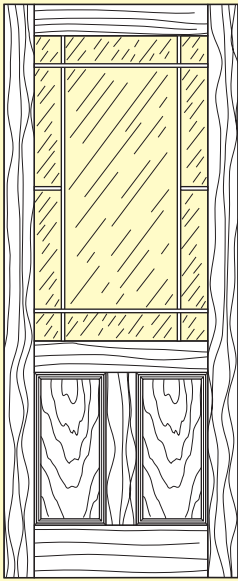

**MARGINAL GLASS**

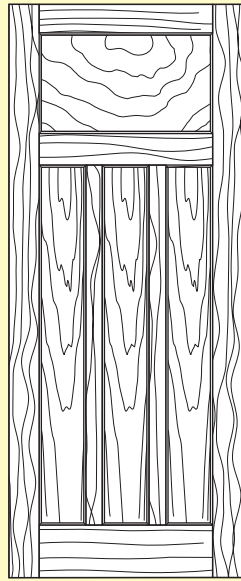

**BUNGALOW**

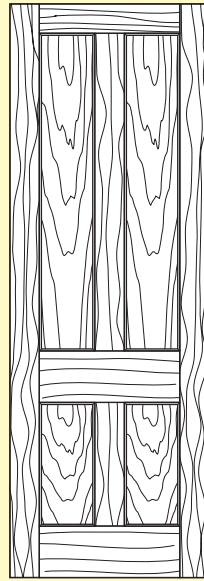

**VILLA**

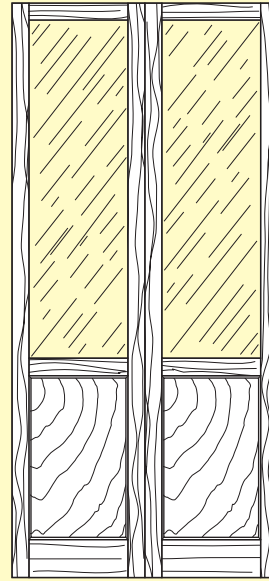

**PAIR LOUVAIN  
 GLAZED**

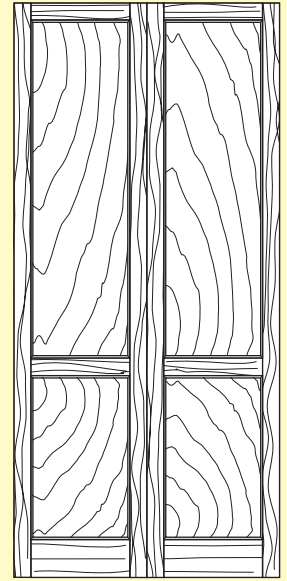

**PAIR LOUVAIN  
 PANEL**

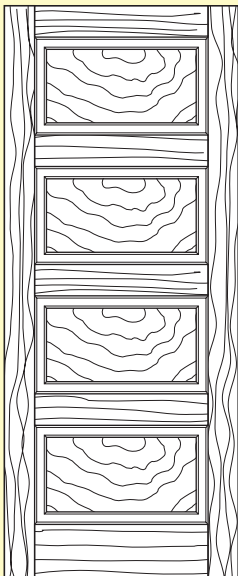

**4.R.P**

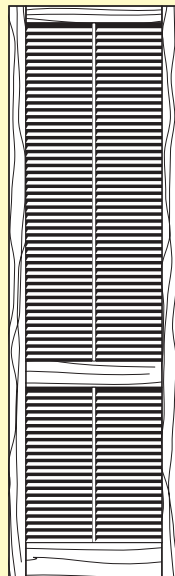

**L.R**

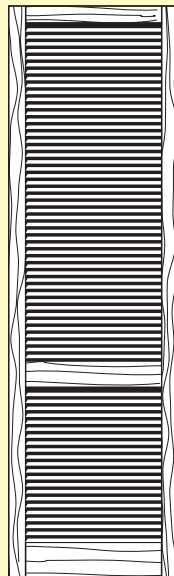

**L.R.C**

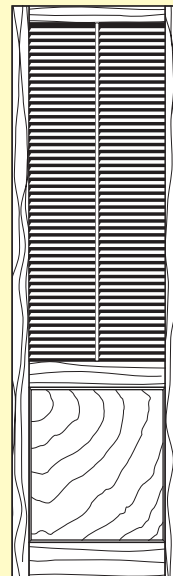

**L.P**

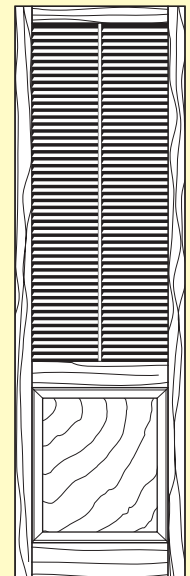

**L.R.P**

## WARRANTY

All doors and windows made by M.J.N. McNaughton Ltd are guaranteed to be of good material and workmanship, and free from defects. Should defects on material and workmanship develop within 12 months, remedial work will be carried out. No liability will be accepted resulting from incorrect installation.

- The manufacturer will not be responsible however, for any damage resulting in failure to the following condition.
- Exterior panel doors are designed for use in weather protected situations only, and should not be subject to direct sunlight and driving rain.
- All surfaces including top and bottom, should be thoroughly sealed after fitting, and before hanging.
- Doors that are exposed to some sunlight should be finished in light reflective colours. Avoid dark tones to minimise the risk of excessive uptake from direct or reflective sunlight.

NOTES: 1. NATURAL VARIATIONS OF COLOUR, TEXTURES, MINOR SHRINKING AND SWELLING OF COMPONENTS, PARTICULARLY PANELS, IS A NORMAL CHARACTERISTIC OF WOOD, WHICH VARIES WITH SEASONAL HUMIDITY CONDITIONS, AND IS NOT CONSIDERED A DEFECT.  
 2. THIS WARRANTY IS ONLY VALID IF FULL PAYMENT HAS BEEN RECEIVED FOR GOODS ON DUE DATE.

Distributed by: